

The information contained in this drawing is the sole property of CWS Coil Winding Specialist. Any reproduction in part or whole without written permission of CWS Coil Winding Specialist is prohibited.



- 7 BUILT TO ROHS COMPLIANCE AND LEAD FREE WHERE SHOWN  
IF APPLICABLE, MARK PART NUMBER AND REVISION
- 6 APPLY EPOXY 2 PARTS
- 5 REMOVE INSULATION AND SOLDER TO BOBBIN LEADS  
WIND BOTH COILS EVENLY SPACED
- 4 CONSTRUCTION:

WEIGHT: ~ 23 GRAMS  
OPERATING TEMP. RANGE: -40°C TO +125°C  
|Z| = 3.3KΩ TYP. @ SRF  
INTERWINDING CAPACITANCE = 9pF TYP @ SRF  
LEAKAGE INDUCTANCE = 10uH TYP  
SRF = 1.7MHZ TYP  
HI-POT TEST FOR INTERWINDING ISOLATION = 1250VDC  
MAX. TEMP RISE AT RATED CURRENT = 20°C  
RATED CURRENT = 5.0 AMPS AC MAX  
DCR = 8.5 MILLI-OHMS MAX. PER WINDING  
L = 750 uH MIN. ±25% @ 100KHz, 250mV

3 SPECIFICATIONS @ 25°C:

WIRE: UL RECOGNIZED 155°C OR 200°C RATED MAGNET WIRE  
CWS BYTEMARK OR OTHER APPROVED PART  
CORE: COATED FERRITE TOROID, HIGH PERM MNZN

2 RATING CLASS B (130°C) REQUIRED

1 MATERIAL: UL RECOGNIZED 94V-0 FLAMMABILITY FOR BOBBIN

NOTES: UNLESS OTHERWISE SPECIFIED, READ FROM BOTTOM UP.  
CAGE CODE: 5DME2

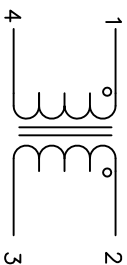

SCHEMATIC

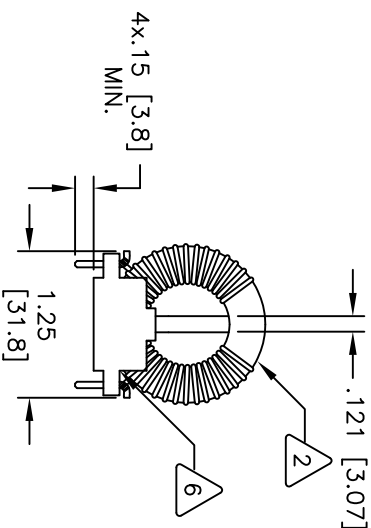

FRONT VIEW

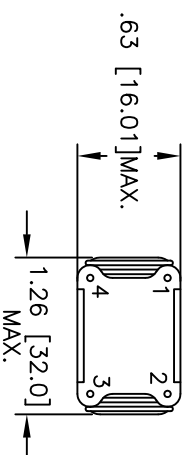

BOTTOM VIEW

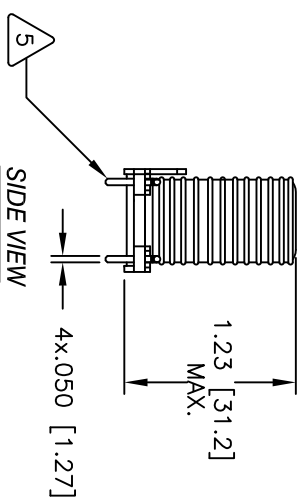

SIDE VIEW

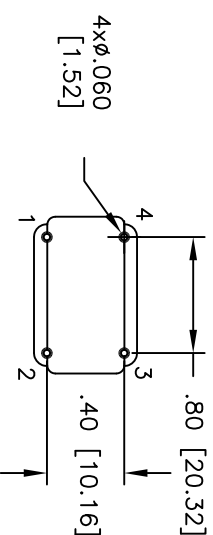

MOUNTING HOLES PATTERN

| REVISION HISTORY |     |                                  |     |         |     |
|------------------|-----|----------------------------------|-----|---------|-----|
| REV              | ECN | DESCRIPTION                      | BY  | DATE    | CHK |
| A                |     | PRODUCTION RELEASE               | RLU | 7/12/07 | JLU |
| A1               |     | UPDATE ELEC. SPEC. & DESCRIPTION | TN  | 2/15/18 | JL  |

| CODE                    | IDENT         | MFG. P/N | DESCRIPTION | ITEM NO. |
|-------------------------|---------------|----------|-------------|----------|
| PARTS LIST              |               |          |             |          |
| AUTOCAD                 | SIGN          | DATE     | DATE        | DATE     |
| SOLIDWORKS              | DATE          | DATE     | DATE        | DATE     |
| DRAWN                   | DATE          | DATE     | DATE        | DATE     |
| CHKD                    | DATE          | DATE     | DATE        | DATE     |
| ENGR.                   | DATE          | DATE     | DATE        | DATE     |
| APPR.                   | DATE          | DATE     | DATE        | DATE     |
| DO NOT SCALE DRAWING    |               |          |             |          |
| TITLE:                  |               |          |             |          |
| Common Mode Line Chokes |               |          |             |          |
| 750uH MIN., 5 Amp       |               |          |             |          |
| SIZE                    | DATE          | DATE     | DATE        | DATE     |
| B                       | PM-12-751U-5A | REV      | A1          |          |
| SCALE                   | 1=1           | SHEET    | 1           | OF 1     |